



Offering a Plus Lifestyle!

Beverly Hills
3 km - about 10 mins

Nagar Road Through Kesnand
9 km - about 12 mins

Theur
9 km - about 20 mins

Solapur Highway
12.7 km - about 15 mins

Outer Ring Road
3 km - about 10 mins

Pune Railway Station
23 km - about 30 mins

Airport
22.4 km - about 31 mins

Eon Kharadi
11.7 km - about 26 mins

Architect & Project Management Consultant
Kalp Gumaste (ARK Consultant)

R.C.C. Consultant
Satish Ghanekar

Legal Advisor
Abhay Jaju

Project by



Sales and Marketed by



Site address: Gat no. 365/366, Near Wadebolai Temple, Wadebolai, Wagholi, Pune

Office address: 211, Skymax Mall, Datta Mandir Chowk, Viman Nagar, Pune

Contact: +91 7719925555 / +91 7719975555 | **Email:** info@sparkrealty.in | **Website:** www.sparkrealty.in

Branches: Akola | Khamgaon | Jalgaon | Nagpur | Buldhana | Aurangabad | Yavatmal

BUDGET FRIENDLY

EXCELLENT RETURNS

EASY CONNECTIVITY

PROGRESSIVE LOCATION

spark
urban **Bliss**

Beyond
expectations...

PLUS MORE!

Why be satisfied with what you have, when every benefit you already have, comes with an added advantage?

It always makes you happy and brings a lot of joy when you get something additional...something with many plus points. Now, live at a destination with plus points exceeding all your expectations and more!



The Plus Points At **URBAN BLISS**

BUDGET FRIENDLY

Expensive. Rising prices. Not affordable.

These are terms we use, rather, have to use every day. There is news of price rises every day. We have to compromise everywhere, all the time. In such a situation, what if you can buy your own home decked with all urban amenities at a price that suits your budget?

We offer you one that would like to be friends with your budget!

PROGRESSIVE LOCATION

All of us want to live in a well equipped area that consists of modern & urban infrastructure. What if you live in an address that is witnessing a major infrastructure boost with a planned Ring Road nearby, and other major roads connecting the area with the most sought after hubs in the city?

We offer you an address that will impress!

EASY CONNECTIVITY

These days, living in an urban city, travelling takes up most of our time. It may be driving to our workplace, going for shopping or entertainment or the kids face problems travelling to-and-fro schools and colleges. In all this, we end up spending more time on the roads & less with our family. Now, what if you live at a destination with not only excellent indoor facilities, but good outdoor connectivity?

We offer you one that wants you to interact with your family more!

EXCELLENT RETURNS

While buying a home, it is not just the immediate and short term benefits that we look at. The value of our asset in the future is also a major point taken into consideration.

What if you live in an area that has already seen good price appreciation and will continue to rise and provide excellent returns over the coming years?

We offer you one from which you and your future generations will always gain!





spark
urban **Bliss**

1 BHK Apartments @ Wadebolai, Wagholi Annexe, Pune
Govt. Sanctioned Scheme. Construction Work Started.

On The Plus Side
OF LIFE...



Spark Urban Bliss, a project of 1 BHK plus homes of 546 square feet, offers you a plus lifestyle at Wagholi Annexe!

You can avail all necessary urban amenities plus your home at a budget friendly price. Experience peace and quiet at your secluded home in Urban Bliss plus enjoy the convenience of easy connectivity to workplaces, schools, malls and entertainment destinations.

Enjoy living in your dream home plus enjoy the appreciation value and excellent returns over the coming years! So come and experience peace plus happiness at Spark Urban Bliss!

spark
urban **Bliss**

Your plus home
1BHK: 546 sq.ft.

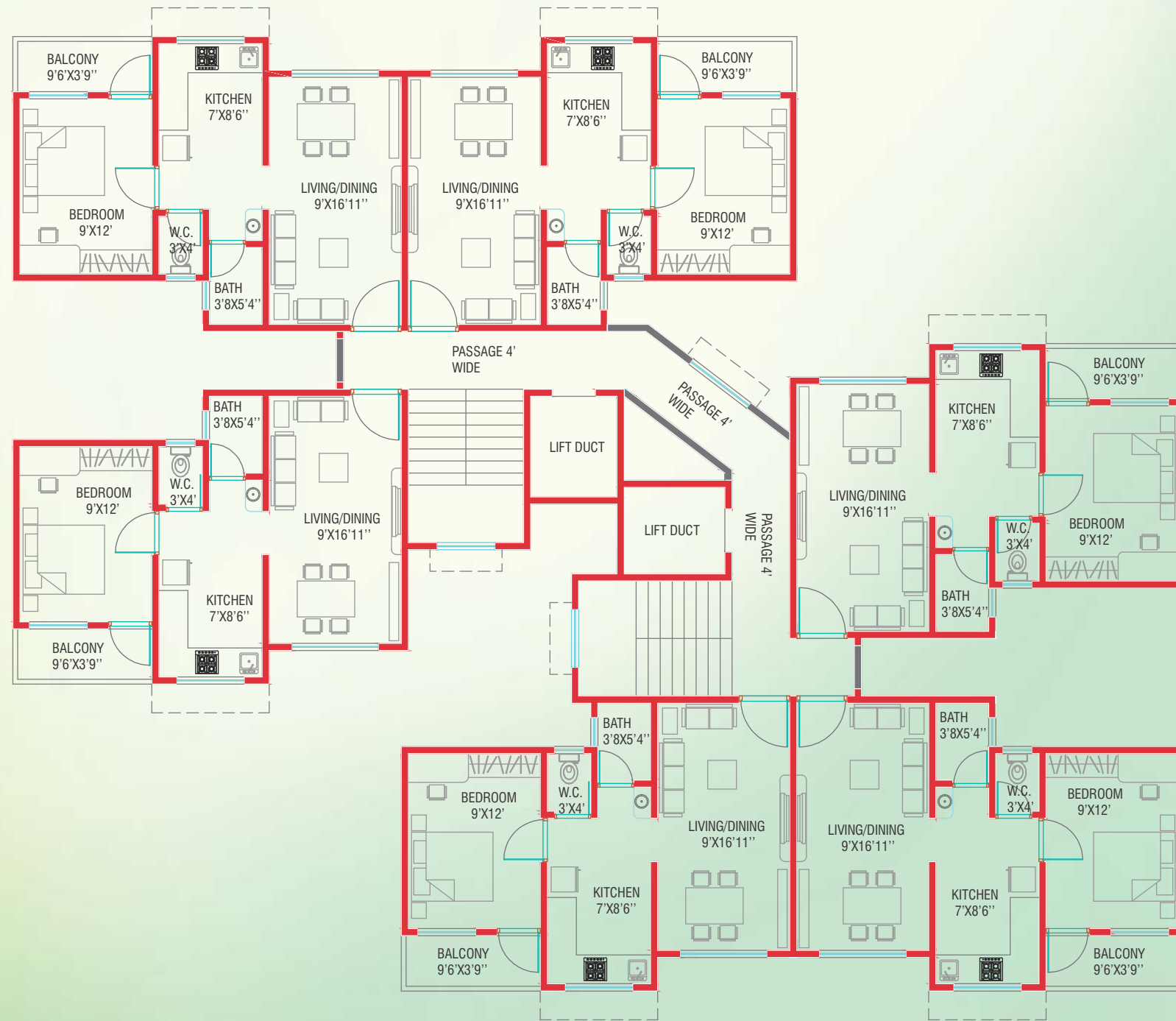

Amenities & **SPECIFICATIONS**

- Ample Parking Area
- Club House
- Landscape Gardens
- Walkway & Jogging Track
- Children's Play Area
- Hi-Speed Lifts
- Elegant Entrance Gate
- Internal Roads
- Swimming Pool
- R.O Purified Water
- Security Intercom Facility
- RCC framed structure
- High quality AAC (Autoclaved Aerated Concrete)
- Blocks used for external & internal walls
- Elegant 2'x2' vitrified flooring in all rooms
- Granite kitchen platform with steel sink
- Concealed wiring of ISI quality & branded
- Wall mounted EWC with premium quality switches fittings
- Designer entrance door with decorative & safety fittings
- Larger windows for natural light & ventilation
- Spacious balcony in every flat
- Sliding windows
- Flats designed for comfortable living

